

■ PREMIER COLLECTION

Alō Recovery

Available: Power, Manual, Power XL, Manual XL



With the same bells and whistles as the Alō Treatment recliner our flagship chair for treatment in oncology and infusion settings, the Alō Recovery has a lower working height for patients and caregivers alike, with use across a variety of acute applications and environments. Infinite recline positions and either stationary or swing-away arms provide optimal patient comfort and better access for providers. These medical recliners are available in a range of fabrics and finishes.



Key Benefits

- Modular in design for adaptable configurations in any facility, and every chair boasts an all-steel base and frame for the most demanding use.
- With fold-away tables, foot trays and quick-release seats, caregivers get more versatility and convenience from a Champion recliner.
- Infinite recline positions and either stationary or swing-away arms provide optimal patient comfort and better access for caregivers.
- For quality engineering and patient-centric innovation that prioritizes functionality, safety, and comfort, Champion products are subject to the ISO and made in the USA.

Common Applications:

Oncology & Infusion Settings

Standard Features



Trendelenburg Positioning



Swing-Away Arms



Foot Tray



Fold-Down Side Table



Push Handle

(Additional standard features are also included. Talk to a Sales Rep for details.)

Space Requirements

Front View

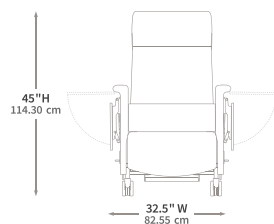

Top View

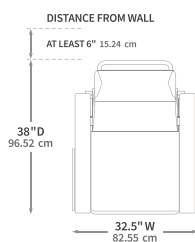

Side View

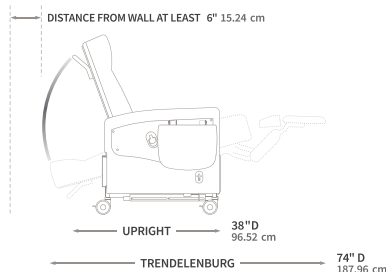

Top View with Swing Away Arms

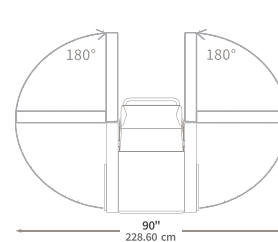

Shown with optional second, fold away table.

Specifications

	Straight Back	Wing Back	XL Straight Back	XL Wing Back
Powered Recline	Yes, Model: 61PL	Yes, Model: 63PL	Yes, Model: 62PL	Yes, Model: 64PL
Manual Recline	Yes, Model: 610L	Yes, Model: 630L	Yes, Model: 620L	Yes, Model: 640L
Weight Capacity	300 lbs. / 136 kg	300 lbs. / 136 kg	500 lbs. / 226 kg	500 lbs. / 226 kg
Back Height (from floor ♦ from seat)	45" ♦ 26.75" 114.30 cm ♦ 67.94 cm	48.50" ♦ 31" 123.19 cm ♦ 78.74 cm	45.50" ♦ 27.25" 115.60 cm ♦ 69.21 cm	49" ♦ 31" 124.50 cm ♦ 78.74 cm
Overall Width (arms closed)	32.50" / 82.60 cm	32.50" / 82.60 cm	36.50" / 92.71 cm	36.50" / 92.71 cm
Seat Width	23" / 58.42 cm	23" / 58.42 cm	27" / 68.60 cm	27" / 68.60 cm
Seat Height ♦ Seat Depth	19.88" ♦ 20.50" 50.48 cm ♦ 52.10 cm	19.88" ♦ 20.50" 50.48 cm ♦ 52.10 cm	19.88" ♦ 20.50" 50.48 cm ♦ 52.10 cm	19.88" ♦ 20.50" 50.48 cm ♦ 52.10 cm
Arm Height (highest point from floor)	29" / 73.70 cm	29" / 73.70 cm	29" / 73.70 cm	29" / 73.70 cm
Overall Upright Depth (with handle)	38" / 96.52 cm	38" / 96.52 cm	43" / 109.22 cm	44" / 111.80 cm
Trendelenburg Depth	74" / 187.96 cm	78" / 198.12 cm	74" / 187.96 cm	78" / 198.12 cm
Dual Thermoplastic Casters (diameter)	4" / 10.16 cm	4" / 10.16 cm	4" / 10.16 cm	4" / 10.16 cm

Available Options



Stylish Black Arm Caps

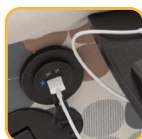

USB Charging Port



Straightback Design



Central-Locking Caster System



Heat + Massage Tablet Switch

(Additional available options are also offered. Talk to a Sales Rep for details.)